

Tumbling & Drying

The **tumbling treatment** is an external treatment used to remove potential shavings created by fusions. It is made by granular inserts of various forms, dimensions and compositions put together with the products that need to be wrought in specific machines called *Buratti*. Thanks to the combined action of rotation and friction, the granular inserts remove the shavings leveling out the surface. This treatment is appropriate to give a special finishing touch to a big amount of products.

Once the tumbling treatment is finished, the **drying process** begins. This process is made with corns' granule and it is used to dry the water left on the surface of the product. In this way it prevents corrosion and damages.

Tumbling



Drying



Without Drying

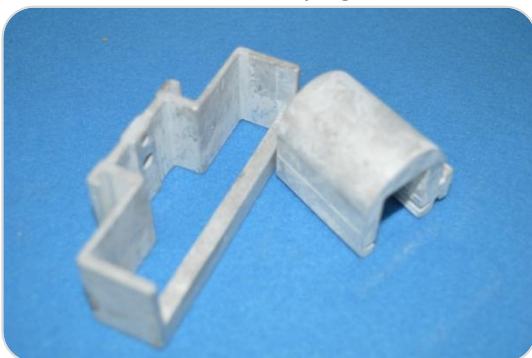

With Drying

